



# KBPC10,15,25,35 SERIES

**SINGLE-PHASE SILICON BRIDGE**  
**Reverse Voltage - 50 to 1000 Volts**  
**Forward Current - 10.0/15.0/25.0/35.0 Amperes**

## Features

- Surge overload 200-400 amperes peak
- Low forward voltage drop
- Mounting position: Any
- Electrically isolated base-1800 volts
- Solderable 0.25" FASTON terminals
- Materials used carries U/L recognition

### KBPC

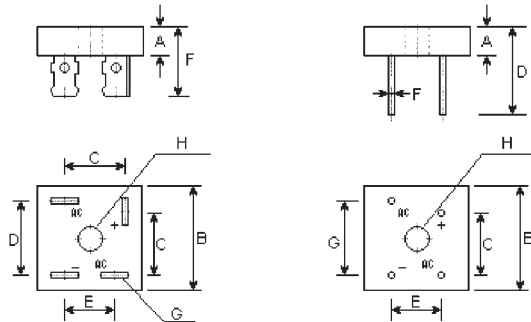

DIM	DIMENSIONS				Note
	inches		mm		
	Min.	Max.	Min.	Max.	
A	0.432	0.442	10.97	11.23	
B	1.12	1.13	28.4	28.7	
C	0.612	0.692	15.5	17.6	
D	0.672	0.752	17.1	19.1	
E	0.512	0.590	13	15	
F	-	1.0	-	25.4	
H	HOLE FOR NO.8 SCREW 0.193(4.9) DIA				

DIM	DIMENSIONS				Note
	inches		mm		
	Min.	Max.	Min.	Max.	
A	0.432	0.442	10.97	11.23	
B	1.12	1.13	28.4	28.7	
C	0.410	0.490	10.4	12.4	
D	1.2	-	30.5	-	
E	0.672	0.752	17.1	19.1	
F	0.04(1.0) DIA Typ.				
G	0.672	0.752	17.1	19.1	
H	HOLE FOR NO. 8 SCREW 0.193(4.9) DIA				

## Maximum Ratings and Electrical Characteristics

Ratings at 25°C ambient temperature unless otherwise specified. Resistive or inductive load 60Hz  
 For capacitive load, derate current by 20%.

	Symbols	KBPC10005 KBPC15005 KBPC25005 KBPC35005	KBPC1001 KBPC1501 KBPC2501 KBPC3501	KBPC1002 KBPC1502 KBPC2502 KBPC3502	KBPC1004 KBPC1504 KBPC2504 KBPC3504	KBPC1006 KBPC1506 KBPC2506 KBPC3506	KBPC1008 KBPC1508 KBPC2508 KBPC3508	KBPC1010 KBPC1510 KBPC2510 KBPC3510	Units
Maximum repetitive peak reverse voltage	$V_{RRM}$	50	100	200	400	600	800	1000	Volts
Maximum RMS bridge input voltage	$V_{RMS}$	35	70	140	280	420	560	700	Volts
Maximum average forward rectified output current at $T_C=55^\circ\text{C}$	$I_{(AV)}$	KBPC10: 10.0 KBPC15: 15.0 KBPC25: 25.0 KBPC35: 35.0							Amps
Peak forward surge current, 8.3mS single half sine-wave superimposed on rated load	$I_{FSM}$	KBPC10: 200.0 KBPC15: 300.0 KBPC25: 300.0 KBPC35: 400.0							Amps
Maximum forward Voltage drop per element at 5.0/7.5/12.5/17.5A peak	$V_F$	1.2							Volts
Maximum DC reverse current at rated DC blocking voltage per element $T_A=25^\circ\text{C}$	$I_R$	10.0							$\mu\text{A}$
Operating temperature range	$T_J$	-55 to +125							$^\circ\text{C}$
Storage temperature range	$T_{STG}$	-55 to +150							$^\circ\text{C}$

Note:

(1) Also available on KBPC10W / 15W / 25W / 35W series



For the complete DATASHEET please visit [www.searchdatasheets.com](http://www.searchdatasheets.com) and [register](#) as a paying customer.

Price starting at: \$50 US for a weekly membership.

\$150 US for 3 months membership, and \$500 US for a yearly membership.

---

“Searchdatasheets provides users with one of the Internet’s most complete sources for obsolete datasheets,” said Ariel Zriel, President, Market Maker Systems.

As the life-cycle of components is shortened by the constant demand for faster and better technology, electronics parts are being rendered obsolete at an unprecedented rate. Searchdatasheets gathers and stores the fact sheets, which explain how to use those components.

“Once a component manufacturer decides to eliminate a component datasheet from its web site,” said Zriel, “we take over and list it along with the millions of other datasheets that our users can quickly access.”

Users can perform standard searches for datasheets, or use the cross-reference search option if they want to find a compatible part from another manufacturer.

Searchdatasheets also informs its users when parts are going to become obsolete, providing them with timely product change notification (PCN), product discontinuation notices (PDN) and end of life (EOL) notification.

Searchdatasheets is the only database of its kind that has components engineers onstaff.

That means users can count on assistance from qualified personnel when performing cross-reference searches. Searchdatasheets engineers also regularly research and add and new datasheets to the system.

“We have full-time Engineers on-staff to research and add datasheets if the information is not currently on our site,” said Zriel. “We are providing a place for users to have their questions answered quickly. Our aim is to build a community for components engineers who need help in product design.”

For information or to contact us:

Market Maker Systems Canada

Phone: 1-514-333-1245

Fax: 1-514-333-1489

Email: [sales@searchdatasheets.com](mailto:sales@searchdatasheets.com)

